

9 PENANG ROAD

Proposed Test Fit

PENANG ROAD

TOWER 2

TOWER 1

TOWER 1

4 - TENANT

PENANG ROAD

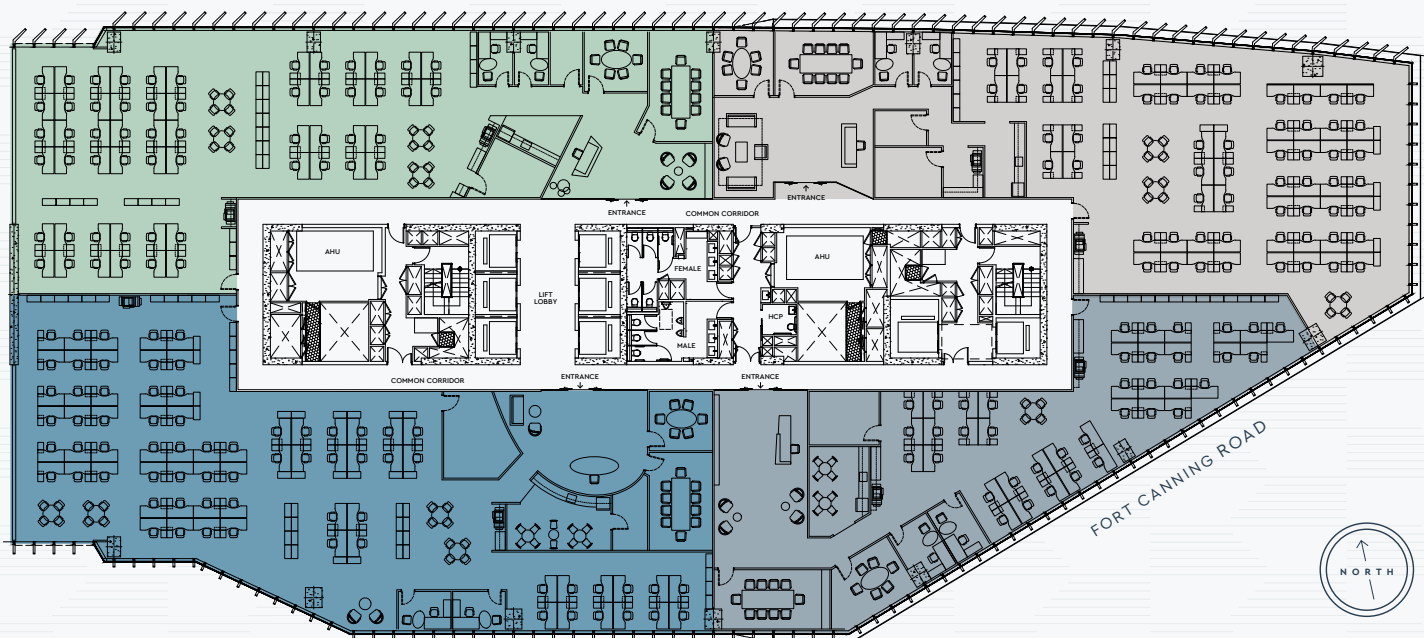

Tenant 1	Approximate Net Lettable Area 5,389 sqft 501 sqm	Tenant 2	Approximate Net Lettable Area 5,747 sqft 534 sqm	Tenant 3	Approximate Net Lettable Area 4,008 sqft 372 sqm	Tenant 4	Approximate Net Lettable Area 6,619 sqft 615 sqm
Office	2	Office	2	Office	2	Office	2
Work Stations	56	Work Stations	62	Work Stations	38	Work Stations	70
Meeting Rooms	2	Meeting Rooms	2	Meeting Rooms	2	Meeting Rooms	2
Total Headcount	59	Total Headcount	65	Total Headcount	41	Total Headcount	73
Density	8.5 sqm/pax	Density	8.2 sqm/pax	Density	9.1 sqm/pax	Density	8.4 sqm/pax