

9 PENANG ROAD

Proposed Test Fit

TOWER 1

2-TENANT

PENANG ROAD

TOWER 2

TOWER 1

PENANG ROAD

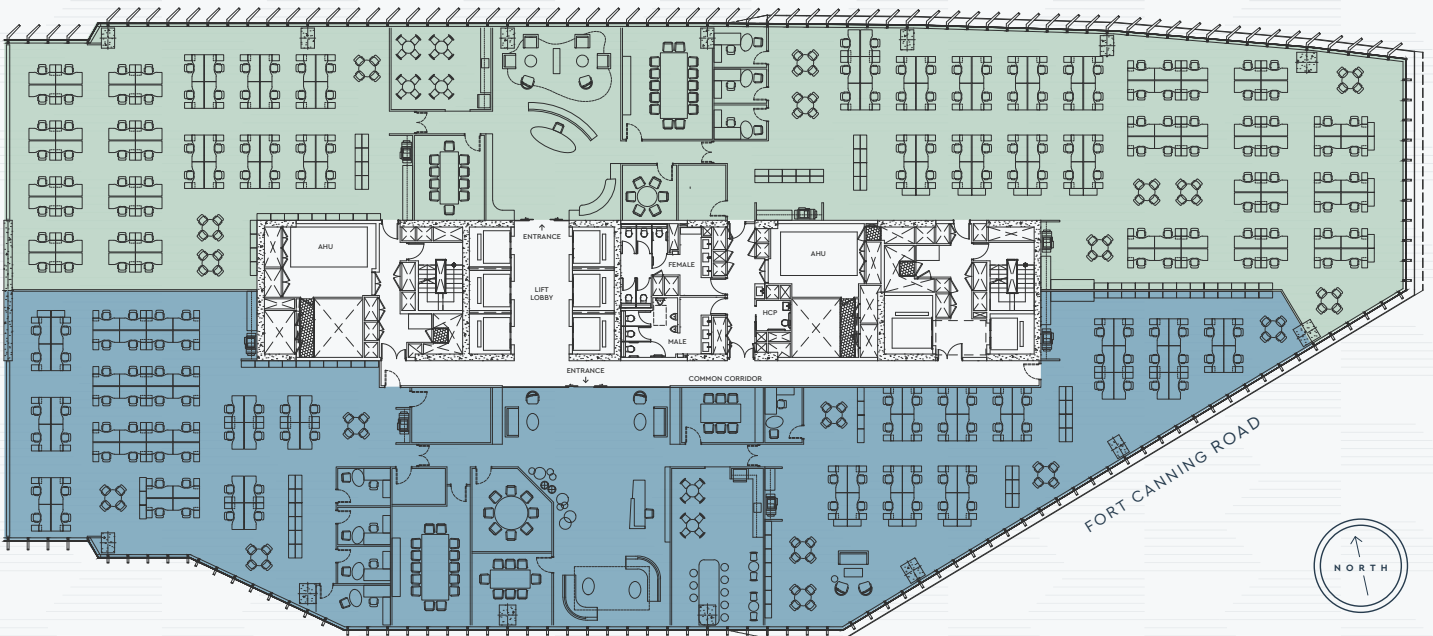

Approximate
Net Lettable Area

12,210 sqft
1,134 sqm

Tenant 1

Office	3
Work Stations	140
Meeting Rooms	3
Total Headcount	144
Density	7.9 sqm/pax

Approximate
Net Lettable Area

10,973 sqft
1,019 sqm

Tenant 2

Office	5
Work Stations	91
Meeting Rooms	4
Total Headcount	95
Density	10.5 sqm/pax